

PRIMARY RECORD

Other Listings

Review Code _____ Reviewer _____ Date _____

Page 1 of 3

Resource Name or #: 210 S CALLE SEVILLE

P1. Other Identifier:

P2. Location: Not for Publication Unrestricted a. County Orange
and (P2b and P2C or P2d. Attach a Location Map as necessary.)

b. USGS 7.5' Quad Date T; R; 1/4 of 1/4 of Sec; B.M.

c. Address 210 S Calle Seville City San Clemente Zip 92672

d. UTM: Zone; mE/ mN

e. Other Locational Data: Assessor Parcel Number: 692-026-12

P3a. Description:

The property contains a one-story single family residence with a rectangular plan and wood-frame construction. Designed in the Spanish Colonial Revival style, it has a low-pitch side-gable roof in the front and a flat roof in the rear, all with non-original clay tiles. The exterior walls are clad with smooth stucco. The fenestration consists of original casement and fixed wood windows throughout the residence. A partial width covered entry porch, with two arched openings cutout of the supporting stucco wall, defines the facade. The residence is in good condition. Its integrity is good.

P3b. Resources Attributes:

P4. Resources Present: Building Structure Object Site District Element of District Other



P5b. Description of Photo:

East elevation, west view. May 2006.

P6. Date Constructed/Sources:

Historic Both
 Prehistoric

1927 (E) Tax Assessor

P7. Owner and Address:

Meredith, Mary J. 210 S Calle Seville

P8. Recorded by:

Historic Resources Group, 1728
Whitley Avenue, Hollywood, CA
90028

P9. Date Recorded: 9/21/2006

P10. Survey Type:

City of San Clemente Historic
Resources Survey Update

P11. Report Citation: None.

Attachments: NONE Location Map Sketch Map Continuation Sheet Building, Structure, and Object Record
 Archaeological Record District Record Linear Feature Record Milling Station Record Rock Art Record
 Artifact Record Photograph Record Other:

DPR 523A (1/95) HRG

BUILDING, STRUCTURE, AND OBJECT RECORD

Page 2 of 3

NRHP Status Code 3D

Resource Name or #: 210 S CALLE SEVILLE

B1. Historic Name: (Unknown)

B2. Common Name: (Unknown)

B3. Original Use: Single-family residential

B4. Present Use: Single-family residential

B5. Architectural Style: Spanish Colonial Revival

B6. Construction History:

B7. Moved? No Yes Unknown

Date: Original Location:

B8. Related Features:

B9a. Architect: (Unknown)

b. Builder: (Unknown)

B10. Significance: Theme Ole Hanson/Spanish Village by the Sea Area City of San Clemente

Period of Significance 1925-1936 Property Type Residential Applicable Criteria A

This one-story single family residence was built in 1927. This property is a typical example of the Spanish Colonial Revival style as represented in San Clemente. This property appears eligible as a contributor to a potential National Register district under Criterion A for its association with the Ole Hanson/Spanish Village by the Sea period of development. It also appears eligible at the local level as a contributor to a potential historic district. It is recommended for retention on the Historic Structures List.

B11. Additional Resource Attributes: 02 Single Family Property

B12. References: Orange County Tax Assessor Records; Historic Resources Survey, Leslie Heumann and Associates, 1995.

B13. Remarks: (none)

B14. Evaluator: Historic Resources Group, Hollywood, CA

Date of Evaluation: 9/21/2006

(This space reserved for official comments.)

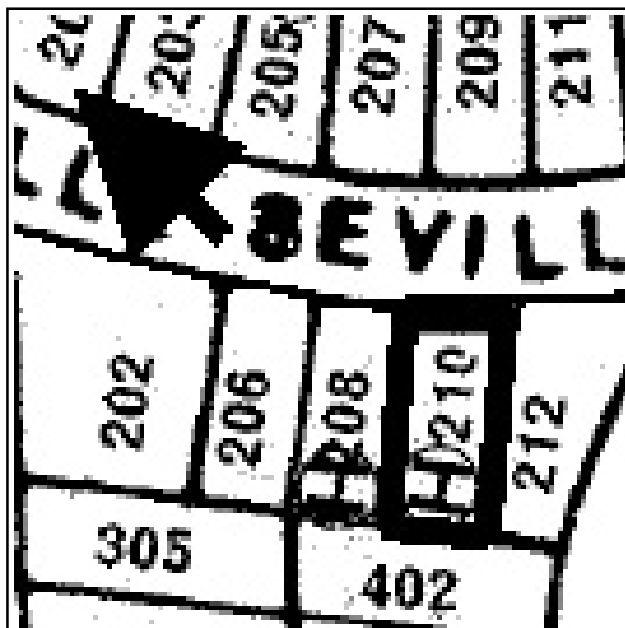

CONTINUATION SHEET

Page 3 of 3

Resource Name or #: 210 S CALLE SEVILLE

Recorded by: Historic Resources Group

Date: 9/21/2006

Continuation Update

Photographs of the Subject Property, Continued:

