

# PRIMARY RECORD

Other Listings

Review Code \_\_\_\_\_ Reviewer \_\_\_\_\_ Date \_\_\_\_\_

Page 1 of 5

Resource Name or #: 111 W AVENIDA PALIZADA

**P1. Other Identifier:** Old City Plaza / Blue Danube Restaurant / Old City Yard / Fire Station / Police Department and City Jail

**P2. Location:**  Not for Publication  Unrestricted a. County Orange

and (P2b and P2C or P2d. Attach a Location Map as necessary.)

b. USGS 7.5' Quad Date T; R; 1/4 of 1/4 of Sec; B.M.

c. Address 111 W Avenida Palizada/104 Avenida Miramar City San Clemente Zip 92672

d. UTM: Zone; mE/ mN

e. Other Locational Data: Assessor Parcel Number: 058-071-43

### P3a. Description:

The property contains a one-story commercial building composed of two distinct sections. The southeasternmost portion of the property, now the Blue Danube Restaurant, contains elements of the City's original fire station. The Spanish Colonial Revival style building features a rectangular plan and wood-frame construction. It features original shed and gabled roofs clad with clay tile. An original square stucco-clad tower is capped by a rounded roof set upon four wood spindled posts. Exterior walls are clad with smooth stucco. The primary facade, facing Avenida Miramar, consists of multiple non-original arched openings. A non-original wood-beam trellis supported by head stucco piers spans the full width of the primary facade. At the time of this Survey Update, this portion of the property was under construction.

(See Continuation Sheet)

**P3b. Resources Attributes:** 06 Commercial Building, 1-3 stories

**P4. Resources Present:**  Building  Structure  Object  Site  District  Element of District  Other



### P5b. Description of Photo:

North elevation, south view. May 2006.

### P6. Date Constructed/Sources:

Historic  Both  
 Prehistoric

1928 (E) Fire station; 1940s Police Station/jail; 1970s shopping plaza.

### P7. Owner and Address:

Brenn, Eric  
2140 Ocean Way, Laguna Beach Ca 92651-3242

### P8. Recorded by:

Historic Resources Group, 1728 Whitley Avenue, Hollywood, CA 90028

**P9. Date Recorded:** 9/21/2006

### P10. Survey Type:

City of San Clemente Historic Resources Survey Update

**P11. Report Citation:** None.

**Attachments:**  NONE  Location Map  Sketch Map  Continuation Sheet  Building, Structure, and Object Record  
 Archaeological Record  District Record  Linear Feature Record  Milling Station Record  Rock Art Record  
 Artifact Record  Photograph Record  Other:

DPR 523A (1/95) HRG

# CONTINUATION SHEET

Page 2 of 5

Resource Name or #: 111 W AVENIDA PALIZADA

Recorded by: Historic Resources Group

Date: 9/21/2006

Continuation  Update

## P3a. DESCRIPTION (continued).

The remainder of the property consists of an attached shopping plaza constructed in the 1970s. This building has a U-shaped plan and wood-frame construction. The building is arranged around a central parking area and contains multiple storefronts occupied by shops and restaurants. It has a shed roof clad with clay tile. The roof shelters an arcade along the entire interior facade of the building, supported by square wood posts with diagonal braces. The exterior walls are clad with rough-finish stucco. Decorative features include exposed rafter tails. The fenestration consists of wood-frame windows throughout the building. The storefront windows include original wood frames, and original transom windows over doorways.

The property is in good condition. Its integrity is fair due to alterations and additions.

# BUILDING, STRUCTURE, AND OBJECT RECORD

Resource Name or #: 111 W AVENIDA PALIZADA

- B1. **Historic Name:** Old City Yard; Fire Station; Police Department and City Jail
- B2. **Common Name:** Old City Plaza; Blue Danube Restaurant
- B3. **Original Use:** First Fire and Police Stations; First City Jail
- B4. **Present Use:** Commercial
- B5. **Architectural Style:** Spanish Colonial Revival
- B6. **Construction History:**

B7. **Moved?**  No  Yes  Unknown      **Date:**      **Original Location:**

B8. **Related Features:**

B9a. **Architect:** (Unknown)

b. **Builder:** Strang Bros.

B10. **Significance:** **Theme** Ole Hanson/Spanish Village by the Sea      **Area** City of San Clemente

**Period of Significance** 1925-1936      **Property Type** Commercial      **Applicable Criteria** A

This one-story commercial building contains remnants of San Clemente's original fire station, constructed in 1928, with an addition of the police department and city jail in the 1940s. This property is a unique example of the Spanish Colonial Revival style as represented in San Clemente. Despite alterations and later additions, this property appears eligible as a contributor to a potential historic district under Criterion A for its association with the Ole Hanson/Spanish Village by the Sea period of development. It is recommended for retention on the Historic Structures List.

B11. **Additional Resource Attributes:** 06 Commercial Building, 1-3 stories

B12. **References:** San Clemente Building Permits; Historic Resources Survey, Leslie Heumann and Associates, 1995.

B13. **Remarks:** (none)

B14. **Evaluator:** Historic Resources Group, Hollywood, CA

**Date of Evaluation:** 9/21/2006

(This space reserved for official comments.)

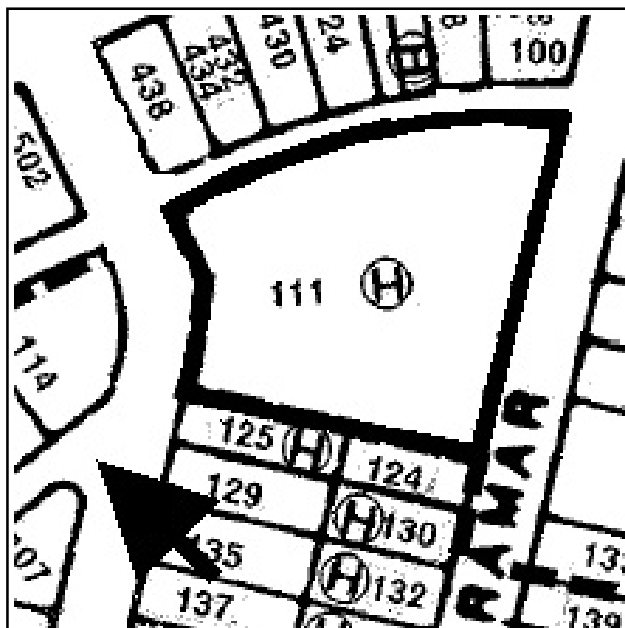

# CONTINUATION SHEET

Page 4 of 5

Resource Name or #: 111 W AVENIDA PALIZADA

Recorded by: Historic Resources Group

Date: 9/21/2006

Continuation  Update

## Photographs of the Subject Property, Continued:



# CONTINUATION SHEET

Page 5 of 5

Resource Name or #: 111 W AVENIDA PALIZADA

Recorded by: Historic Resources Group

Date: 9/21/2006

Continuation  Update

## Photographs of the Subject Property, Continued:

