

PRIMARY RECORD

Other Listings

Review Code _____ Reviewer _____ Date _____

Page 1 of 3

Resource Name or #: 165 AVENIDA MIRAMAR

P1. Other Identifier:

P2. Location: Not for Publication Unrestricted a. County Orange

and (P2b and P2C or P2d. Attach a Location Map as necessary.)

b. USGS 7.5' Quad Date T; R; 1/4 of 1/4 of Sec ; B.M.

c. Address 165 Avenida Miramar City San Clemente Zip 92672

d. UTM: Zone ; mE/ mN

e. Other Locational Data: Assessor Parcel Number: 058-072-01

P3a. Description:

The property contains a one-story single family residence with a rectangular plan and wood-frame construction. Designed in the Spanish Colonial Revival style, it has a medium pitch front-gable roof with clay tiles and exposed rafter tails. The exterior walls are clad with stucco. A shed roof covers the entryway on Miramar, while a covered entryway is on the Ola Vista facade of the residence. Decorative features of the Spanish Colonial Revival style include exposed rafter tails, a stucco chimney, and a low stucco wall that encloses a courtyard. The fenestration consists of non-original but compatible wood windows throughout the residence. The residence is in good condition. Its integrity is good.

P3b. Resources Attributes: 02 Single Family Property

P4. Resources Present: Building Structure Object Site District Element of District Other



P5b. Description of Photo:

West elevation, east view. May 2006.

P6. Date Constructed/Sources:

Historic Both
 Prehistoric

1928 (E) Tax Assessor

P7. Owner and Address:

Bodas, James
165 Avenida Miramar

P8. Recorded by:

Historic Resources Group, 1728
Whitley Avenue, Hollywood, CA
90028

P9. Date Recorded: 9/20/2006

P10. Survey Type:

City of San Clemente Historic
Resources Survey Update

P11. Report Citation: None.

Attachments: NONE Location Map Sketch Map Continuation Sheet Building, Structure, and Object Record
 Archaeological Record District Record Linear Feature Record Milling Station Record Rock Art Record
 Artifact Record Photograph Record Other:

DPR 523A (1/95) HRG

BUILDING, STRUCTURE, AND OBJECT RECORD

Page 2 of 3

NRHP Status Code 3D

Resource Name or #: 165 AVENIDA MIRAMAR

B1. Historic Name: (Unknown)

B2. Common Name: (Unknown)

B3. Original Use: Single-family residential

B4. Present Use: Single-family residential

B5. Architectural Style: Spanish Colonial Revival

B6. Construction History:

B7. Moved? No Yes Unknown

Date: Original Location:

B8. Related Features:

B9a. Architect: (Unknown)

b. Builder: (Unknown)

B10. Significance: Theme Ole Hanson/Spanish Village by the Sea Area City of San Clemente

Period of Significance 1925-1936 Property Type Residential Applicable Criteria A

This one-story single family residence was built in 1928. This property is a typical example of the Spanish Colonial Revival style as represented in San Clemente. This property appears eligible as a contributor to a potential National Register district under Criterion A for its association with the Ole Hanson/Spanish Village by the Sea period of development. It also appears eligible at the local level as a contributor to a potential historic district. It is recommended for retention on the Historic Structures List.

B11. Additional Resource Attributes: 02 Single Family Property

B12. References: Orange County Tax Assessor Records; Historic Resources Survey, Leslie Heumann and Associates, 1995.

B13. Remarks: (none)

B14. Evaluator: Historic Resources Group, Hollywood, CA

Date of Evaluation: 9/20/2006

(This space reserved for official comments.)

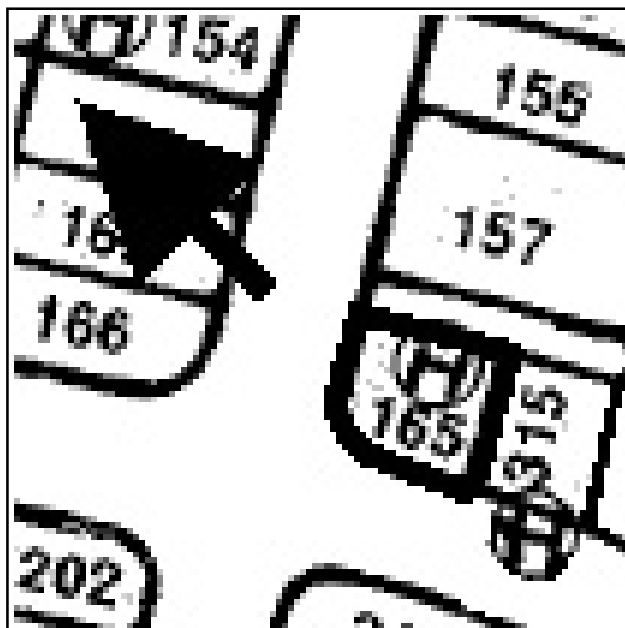

CONTINUATION SHEET

Page 3 of 3

Resource Name or #: 165 AVENIDA MIRAMAR

Recorded by: Historic Resources Group

Date: 9/20/2006

Continuation Update

Photographs of the Subject Property, Continued:

